

# HMS INDUSTRIES

27995 Ranney Parkway • Westlake, Ohio 44145

Phone 440-899-0001 • Toll-free 800-522-7127 • Fax 440-899-2661 • Email info@hms-ind.com • Web [hms-ind.com](http://hms-ind.com)

## Full Complement Series – Needle Bearings

Bearing No.		Bore (d)		Outer Diameter (D)		Width (B)	
open end full comp.	closed end full comp.	mm	in	mm	in	mm	in
B-24	-	3.175	0.125	6.35	0.25	6.35	0.25
B-2-1/2-4	-	3.9624	0.156	7.1374	0.281	6.35	0.25
B-2-1/2-5	-	3.9624	0.156	7.1374	0.281	7.9248	0.312
B-34	M-341	4.7752	0.188	8.7376	0.344	6.35	0.25
B-36	M-361	4.7752	0.188	8.7376	0.344	9.525	0.375
B-44	M-441	6.35	0.25	11.0998	0.437	6.35	0.25
B-45	M-451	6.35	0.25	11.0998	0.437	7.9248	0.312
B-46	-	6.35	0.25	11.1252	0.438	9.525	0.375
B-47	M-471	6.35	0.25	11.0998	0.437	11.1252	0.438
B-55	M-551	7.9502	0.313	12.7	0.5	7.9248	0.312
B-56	-	7.9502	0.313	12.7	0.5	9.525	0.375
B-57	M-571	7.9502	0.313	12.7	0.5	11.1252	0.438
B-59	-	7.9502	0.313	12.7	0.5	14.2748	0.562
BH-57	MH-571	7.9502	0.313	14.3002	0.563	11.1252	0.438
BH-59	-	7.9502	0.313	14.3002	0.563	14.2748	0.562
B-65	M-651	9.525	0.375	14.3002	0.563	7.9248	0.312
B-66	M-661	9.525	0.375	14.3002	0.563	9.525	0.375
B-67	-	9.525	0.375	14.3002	0.563	11.1252	0.438
B-68	M-681	9.525	0.375	14.3002	0.563	12.7	0.5
B-69	-	9.525	0.375	14.3002	0.563	14.2748	0.562
B-610	M-6101	9.525	0.375	14.3002	0.563	15.875	0.625
BH-68	-	9.525	0.375	15.875	0.625	12.7	0.5
B-76	-	11.0998	0.437	15.875	0.625	9.525	0.375
B-77	-	11.0998	0.437	15.875	0.625	11.1252	0.438
B-78	M-781	11.0998	0.437	15.875	0.625	12.7	0.5
B-710	-	11.0998	0.437	15.875	0.625	15.875	0.625
BH-78	-	11.1252	0.438	17.4752	0.688	12.7	0.5
B-85	M-851	12.7	0.5	17.4498	0.687	7.9248	0.312
B-86	M-861	12.7	0.5	17.4498	0.687	9.525	0.375
B-87	M-871	12.7	0.5	17.4498	0.687	11.1252	0.438
B-88	M-881	12.7	0.5	17.4498	0.687	12.7	0.5
B-810	M-8101	12.7	0.5	17.4498	0.687	15.875	0.625
B-812	M-8121	12.7	0.5	17.4498	0.687	19.05	0.75
BH-87	-	12.7	0.5	19.05	0.75	11.1252	0.438
BH-88	-	12.7	0.5	19.05	0.75	12.7	0.5
BH-810	-	12.7	0.5	19.05	0.75	15.875	0.625
BH-812	MH-8121	12.7	0.5	19.05	0.75	19.05	0.75
B-95	M-951	14.3002	0.563	19.05	0.75	7.9248	0.312
B-96	M-961	14.3002	0.563	19.05	0.75	9.525	0.375
B-97	M-971	14.3002	0.563	19.05	0.75	11.1252	0.438
B-98	M-981	14.3002	0.563	19.05	0.75	12.7	0.5
B-910	M-9101	14.3002	0.563	19.05	0.75	15.875	0.625
B-912	M-9121	14.3002	0.563	19.05	0.75	19.05	0.75
BH-98	-	14.3002	0.563	20.6502	0.813	12.7	0.5
BH-910	-	14.3002	0.563	20.6502	0.813	15.875	0.625
BH-912	-	14.3002	0.563	20.6502	0.813	19.05	0.75
B-105	M-1051	15.875	0.625	20.6502	0.813	7.9248	0.312
B-107	M-1071	15.875	0.625	20.6502	0.813	11.1252	0.438
B-108	M-1081	15.875	0.625	20.6502	0.813	12.7	0.5

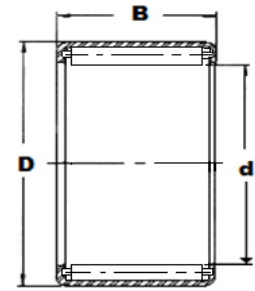

OPEN

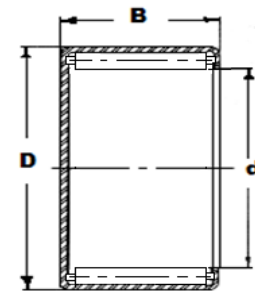

CLOSED

B-1010	M-10101	15.875	0.625	20.6502	0.813	15.875	0.625
B-1012	M-10121	15.875	0.625	20.6502	0.813	19.05	0.75
BH-108	M-1081	15.875	0.625	22.225	0.875	12.7	0.5
BH-1010	-	15.875	0.625	22.225	0.875	15.875	0.625
BH-1012	-	15.875	0.625	22.225	0.875	19.05	0.75
BH-1016	-	15.875	0.625	22.225	0.875	25.4	1
B-116	M-1161	17.4498	0.687	22.225	0.875	9.525	0.375
B-118	M-1181	17.4498	0.687	22.225	0.875	12.7	0.5
B-1110	M-11101	17.4498	0.687	22.225	0.875	15.875	0.625
B-1112	M-11101	17.4498	0.687	22.225	0.875	19.05	0.75
BH-117	-	17.4752	0.688	23.8252	0.938	11.1252	0.438
BH-1110	MH-11101	17.4752	0.688	23.8252	0.938	15.875	0.625
BH-1112	-	17.4752	0.688	23.8252	0.938	19.05	0.75
B-126	M-1261	19.05	0.75	25.4	1	9.525	0.375
B-128	M-1281	19.05	0.75	25.4	1	12.7	0.5
B-1210	M-12101	19.05	0.75	25.4	1	15.875	0.625
B-1212	M-12121	19.05	0.75	25.4	1	19.05	0.75
B-136	-	20.6502	0.813	27.0002	1.063	9.525	0.375
B-138	M-1381	20.6502	0.813	27.0002	1.063	12.7	0.5
B-1314	M-13141	20.6502	0.813	27.0002	1.063	22.225	0.875
B-1316	M-13161	20.6502	0.813	27.0002	1.063	25.4	1
B-1320	-	20.6502	0.813	27.0002	1.063	31.75	1.25
BH-138	MH-1381	20.6502	0.813	28.575	1.125	12.7	0.5
BH-1310	MH-13101	20.6502	0.813	28.575	1.125	15.875	0.625
BH-1312	MH-13121	20.6502	0.813	28.575	1.125	19.05	0.75
B-146	M-1461	22.225	0.875	28.575	1.125	9.525	0.375
B-148	M-1481	22.225	0.875	28.575	1.125	12.7	0.5
B-1412	M-14121	22.225	0.875	28.575	1.125	19.05	0.75
B-1416	M-14161	22.225	0.875	28.575	1.125	25.4	1
B-1418	-	22.225	0.875	28.575	1.125	28.575	1.125
BH-1410	MH-14101	22.225	0.875	30.1752	1.188	15.875	0.625
BH-1412	MH-14121	22.225	0.875	30.1752	1.188	19.05	0.75
BH-1416	-	22.225	0.875	30.1752	1.188	25.4	1
B-158	-	23.7998	0.937	30.1498	1.187	12.7	0.5
B-1516	M-15161	23.7998	0.937	30.1498	1.187	25.4	1
B-166	-	25.4	1	31.75	1.25	9.525	0.375
B-167	M-1671	25.4	1	31.75	1.25	11.1252	0.438
B-1610	M-16101	25.4	1	31.75	1.25	15.875	0.625
B-1612	M-16121	25.4	1	31.75	1.25	19.05	0.75
B-1616	M-16161	25.4	1	31.75	1.25	25.4	1
BH-168	MH-1681	25.4	1	33.3502	1.313	12.7	0.5
BH-1610	-	25.4	1	33.3502	1.313	15.875	0.625
BH-1612	MH-16121	25.4	1	33.3502	1.313	19.05	0.75
BH-1614	-	25.4	1	33.3502	1.313	22.225	0.875
BH-1616	MH-16161	25.4	1	33.3502	1.313	25.4	1
BH-1620	-	25.4	1	33.3502	1.313	31.75	1.25
BH-1624	MH-16241	25.4	1	33.3502	1.313	38.1	1.5
B-1710	M-17101	27.0002	1.063	33.3502	1.313	15.875	0.625
BH-1712	-	27.0002	1.063	34.925	1.375	19.05	0.75
B-186	M-1861	28.575	1.125	34.925	1.375	9.525	0.375
B-188	M-1881	28.575	1.125	34.925	1.375	12.7	0.5
B-1810	-	28.575	1.125	34.925	1.375	15.875	0.625
B-1812	M-18121	28.575	1.125	34.925	1.375	19.05	0.75
B-1816	M-18161	28.575	1.125	34.925	1.375	25.4	1
BH-1812	MH-18121	28.575	1.125	38.1	1.5	19.05	0.75
BH-1816	MH-18161	28.575	1.125	38.1	1.5	25.4	1
BH-1820	MH-18201	28.575	1.125	38.1	1.5	31.75	1.25
B-1910	M-19101	30.1498	1.187	38.1	1.5	15.875	0.625
B-1916	-	30.1498	1.187	38.1	1.5	25.4	1
B-208	M-2081	31.75	1.25	38.1	1.5	12.7	0.5