



**BEARINGS SPECIFICALLY  
ENGINEERED FOR THE  
LAWN & GARDEN AND  
AGRICULTURAL INDUSTRIES**



***HMS* INDUSTRIES**





**THE PRIMARY REASON FOR PREMATURE BEARING FAILURE IN RESIDENTIAL AND COMMERCIAL EQUIPMENT IS CONTAMINATION.**

**HMS PROOF IS ENGINEERED TO COMBAT CONTAMINATION, THUS ADDING LIFE TO THE BEARING.**

## **PREMIUM BEARING SEAL TECHNOLOGY**

Developed for the Lawn & Garden and Agricultural Industries to increase bearing life and eliminate water and dust penetration.

Our patented seal technology has excelled through years of customer testing in extreme conditions to keep bearings water and dust **PROOF**.

## **REDUCE WARRANTY ISSUES WITH THE LATEST SEAL TECHNOLOGY**

HMS hybrid seal design is superior against debris and water intrusion. Patented sealed bearings come sealed on one side or both sides.





# THE PROOF IS IN THE TESTING



**NAPOLEON  
ENGINEERING  
SERVICES**



Independent Testing proves that the HMS **PROOF** seal has a distinct advantage over the competition.

NES finds that the HMS bearing samples exhibit statistically significant better mean seal efficiency than the competitors' samples. After performing a T-Test to evaluate differences between the populations of runtime weighted scores, the results show with at least a 95% confidence that a statistically significant difference in the means of the runtime weighted scores exists between the bearing variations tested.

The Environmental Mud Slurry Test Stand is designed to contain sixteen (16) test bearings and housings. An electric motor is utilized to drive a belt and sheave system turning the bearings at 500 RPM. The test environment was created by splashing the bearings with mud slurry mixture agitated by rotating paddles mounted below the bearings.

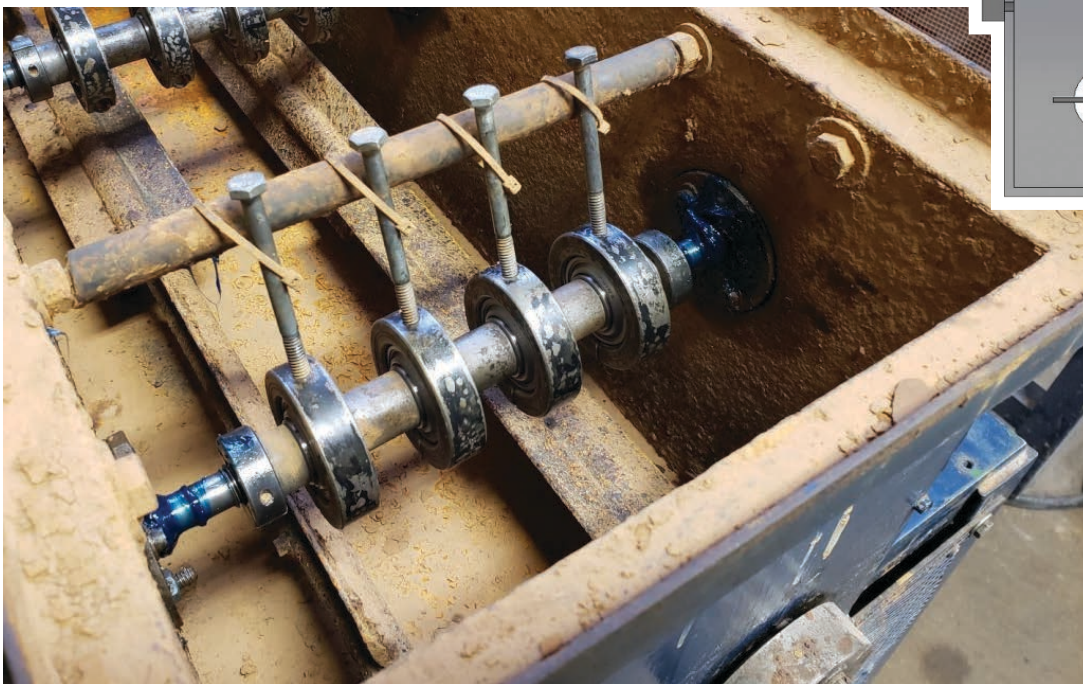
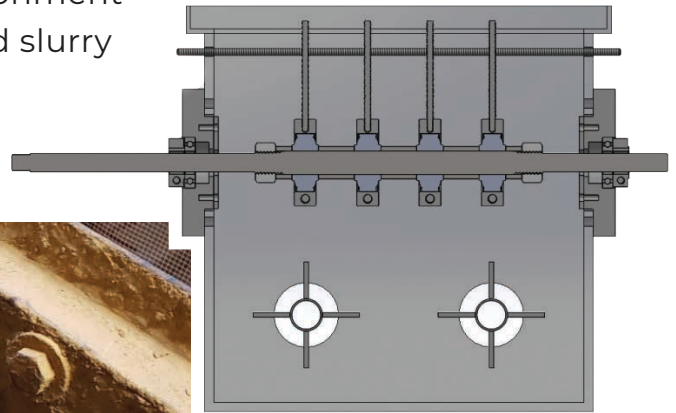

# BALL BEARING SEALING OPTIONS

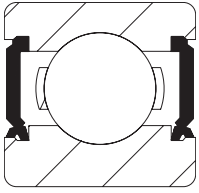

## SEAL “RSD” / “2RSD”

- Bearings with rubber seal on one side “RSD” or both sides “2RSD” (Example: 6205.RSD, 6205.2RSD).
- Bearings with seals come with packed grease.
- Seals can be removed without permanently damaging them and can be pressed back on.
- “RSD” seals are double lip contact (typically inner ring will have groove).

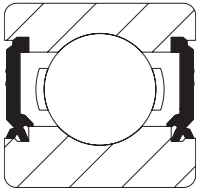

## SEAL “RSVX” / “2RSVX”

- Bearings with rubber seal on one side “RSVX” or both sides “2RSVX” (Example: 6205.RSVX, 6205.2RSVX).
- Bearings with seals come with packed grease.
- Seals can be removed without permanently damaging them and can be pressed back on.
- “RSVX” seals are triple lip contact (inner ring will have groove).

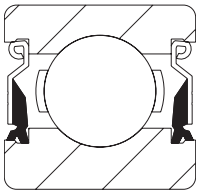

## TRASH GUARD SEAL “RSDT” / “2RSDT”

- Bearings with trash guard seal on one side “RSDT” or both sides “2RSDT” (Example: 6205.RSDT, 6205.2RSDT).
- Special hybrid seal comes with pressed steel shield and double lip contact seal.
- Efficient against external debris damage and debris/water intrusion into the bearing.
- Bearings with trash guard seals come with packed grease.

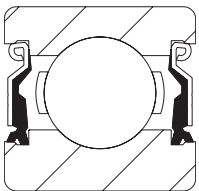

## TRASH GUARD SEAL “RSXT” / “2RSXT” (PATENT PUBLISHED)

- Bearings with trash guard seal on one side “RSXT” or both sides “2RSXT” (Example: 6205.RSXT, 6205.2RSXT).
- Special hybrid seal comes with pressed steel shield and double lip contact seal (patented design constructed for superior sealing against water intrusion).
- Superior against external debris damage and debris/water intrusion into the bearing.
- Bearings with trash guard seals come with packed grease.

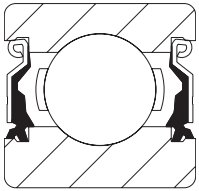

## TRASH GUARD SEAL “RSXT-3” / “2RSXT-3” (PATENT PUBLISHED)

- Bearings with trash guard seal on one side “RSXT-3” or both sides “2RSXT-3” (Example: 6205.RSXT-3, 6205.2RSXT-3).
- Special hybrid seal comes with pressed steel shield and triple lip contact seal (patented design constructed for superior sealing against water intrusion).
- Superior against external debris damage and debris/water intrusion into the bearing.
- Bearings with trash guard seals come with packed grease.

# PREMIUM BEARING SEAL TECHNOLOGY

## HMS-6203EIX.2RSXTU.C3.SRI

- Triple lip; water **PROOF** / dust **PROOF**; trash guard seal.
- Press wheel applications.
- Interchange: 203KRR50, 203KRR50-SP1.
- Independently tested by Napoleon Engineering Services.



## HMS-5203.WDDU

- Triple lip seal & Trash Guard Shield.
- Closing wheel & gauge wheel applications.
- Interchange: 5203KPP2, AN212132, AG301P, 5203KYY2.
- Independently tested by Napoleon Engineering Services.



**BEARINGS DEVELOPED  
SPECIFICALLY FOR  
THE AGRICULTURAL AND  
LAWN & GARDEN INDUSTRIES**







## MOWER DECK SPINDLE, PULLEY, & WHEEL

HMS patented “RSXT” seal design eliminates the need for additional end cap seal protection which saves on overall spindle & pulley cost, as well as assembly time.

HMS bearings have been developed and tested to assist mower deck spindles in meeting even the harshest operating conditions.

The bottom of mower decks are a place that is subjected to constant debris, grass cuttings, sticks, and dirt. HMS sealed bearings are integral in preventing contamination.

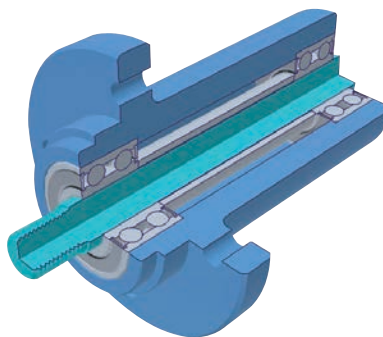

## HMS-6203.2RSXT.C3.SRI

- RSXT seal design double lip machine groove; trash guard dust **PROOF** / water **PROOF** seal.
- Superior against debris and water intrusion.
- Currently used by John Deere and many reputable OEM's through multiple idler pulley manufacturers.
- Independently tested by Napoleon Engineering Services.



---

## HMS-99502H.NR.2RSXT

- RSXT seal design double lip machine groove; trash guard dust **PROOF** / water **PROOF** seal.
- Superior against debris and water intrusion in wheel applications.
- Bearings come with repacked grease which reduces maintenance and machine downtime.
- Currently used by John Deere and many reputable OEM's.



---

## HMS-Z9504.2RSXT.C3.SRI

- RSXT seal design double lip machine groove; trash guard dust **PROOF** / water **PROOF** seal.
- Superior against debris and water intrusion in idler pulleys.
- Bearings come with repacked grease, which reduces maintenance and machine downtime.
- Currently used by many reputable OEM's through multiple idler pulley manufacturers.







## CURRENTLY AVAILABLE 2RSXT SEAL SIZES

HMS-5206.2RSXT.C3  
HMS-6203.2RSXT.C3.SRI  
HMS-6204.2RSXT.C3.SRI  
HMS-6205.2RSXT.C3.SRI  
HMS-6206.2RSXT.C3.SRI  
HMS-6203.2RSXT.C3.SRI  
HMS-6204.2RSXT.C3.SRI  
HMS-6205.2RSXT.C3.SRI

HMS-6305.2RSXT.C3.SRI  
HMS-6203EIX.2RSXTU.C3.SRI  
HMS-83607.2RSXT.C4.AV2  
HMS-99502H.NR.2RSXT  
HMS-99502H-3/4.XNR.2RSD  
HMS-DAC305523.2RSXT  
HMS-Z9504.2RSXT.C3.SRI

The HMS **PROOF** seal is being designed to new bearing sizes continuously. Contact HMS to see if the RSXT seal is right for your application.

**HMS** INDUSTRIES

